

5

## Remove lock rod and Secure liner

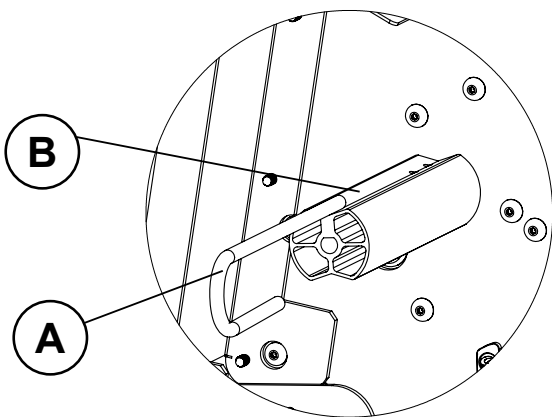

- A: Slide lock rod off of take-up hub
- B: Secure label liner onto take-up hub and
- C: Slide lock rod back on to take-up hub with 2-3" (50-75mm) of liner beyond the lock rod.

6

## Adjust Brush Pressure

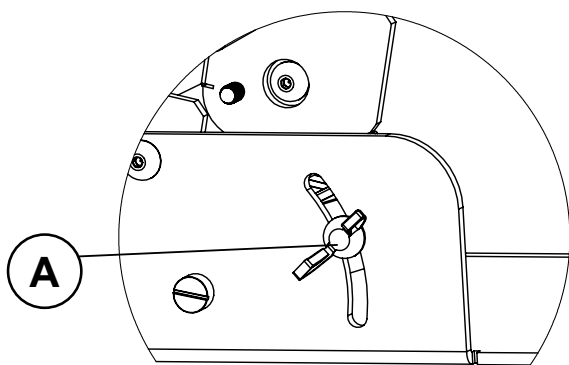

- A: To apply the proper amount of tension for proper label feeding and detection; loosen brush wing screw and press down to increase tension, then tighten screw.

7

## Adjust Label Sensor

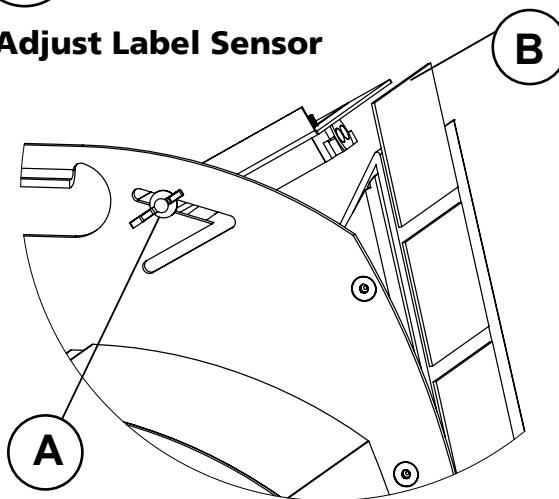

- A: Loosen wing screw, then adjust sensor plate.
- B: Point sensor towards the top edge of the label.
- C: Tighten wing screw to secure sensor in place.

8

## Plug In & Turn On

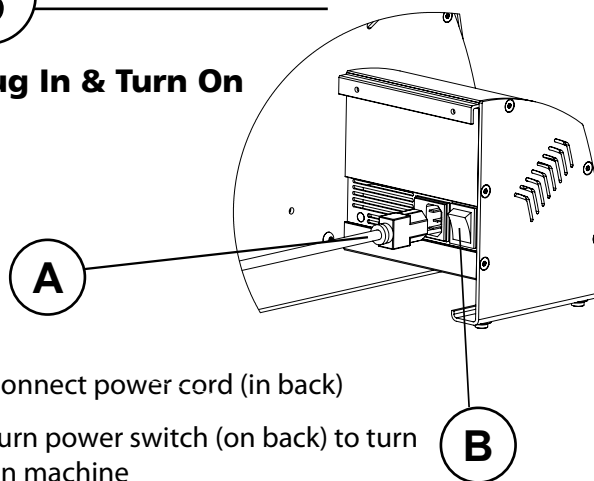

- A: Connect power cord (in back)
- B: Turn power switch (on back) to turn on machine

**Now you're ready to roll.**

Need more help? Download the full manual or contact us.



# QuickSTART Guide

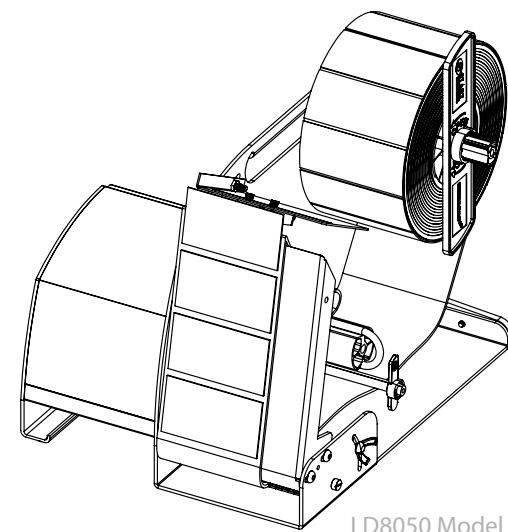

LD8050 Model Shown

LD8025	LD8050	LD8100
LDX8025	LDX8050	LDX8100

Manufactured in the U.S.A. by



4270 Airborn Dr | Addison, TX 75001, USA  
972.248.1999 | [service@startinternational.com](mailto:service@startinternational.com)  
[www.STARTinternational.com](http://www.STARTinternational.com)

# LD8025, LD8050, LD8100 LDX8025, LDX8050, LDX8100

## Electric Label Dispenser

### ITEMS INCLUDED

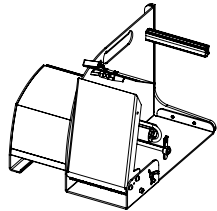

Machine

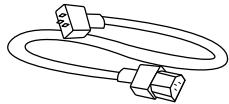

Power Cord

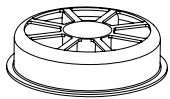

Core Holders (2)

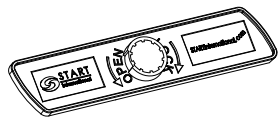

Large Hub Lock

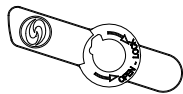

Small Hub Lock (2)

### ELECTRICAL INFORMATION

- Supply outlet must provide Protective Earth to the equipment.
- Danger - High Voltage! No user serviceable parts. Access is for trained service persons only.
- Run/Rest Time (1S/5S)

#### ELECTRICAL RATINGS

LD8025, 115V AC, 0.75A 60Hz  
LD8025-2, 220-240V AC, 0.4A 50Hz  
LDX8025, 115V AC, 0.75A 60Hz  
LDX8025-2, 220-240V AC, 0.4A 50Hz  
LD8050, 115V AC, 2.5A 60Hz  
LD8050-2, 220-240V AC, 1.8A 50/60Hz  
LDX8050, 115V AC, 2.5A 60Hz  
LDX8050-2, 220-240V AC, 1.8A 50/60Hz  
LD8100, 115V AC, 2.5A 60Hz  
LD8100-2, 220-240V AC, 2A 50Hz  
LDX8100, 115V AC, 2.5A 60Hz  
LDX8100-2, 220-240V AC, 2A 50Hz

\*Machine must be unplugged from power supply for Steps 1 to 7.

1

#### Load Label Roll

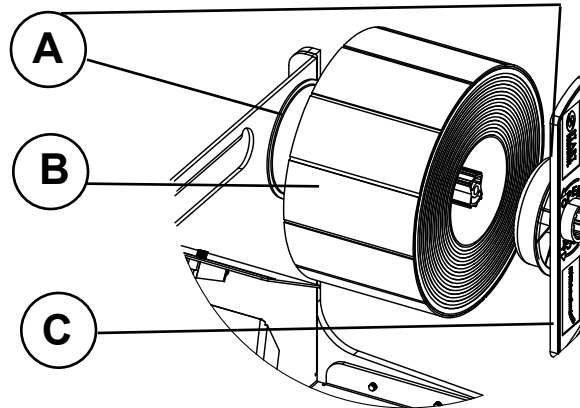

- A: Insert core holders (2) into each side of your label roll  
B: Slide label roll onto reel hanger bar  
C: Rotate the large hub lock **Gently** clockwise until it locks into place

2

#### Feed Labels

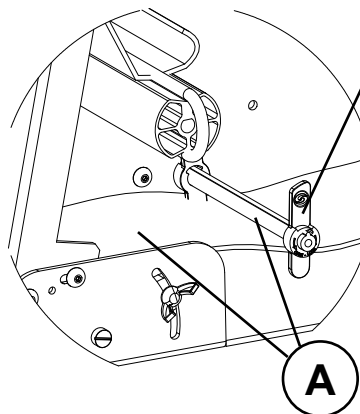

- A: Feed label liner under guide rod  
B: Hub Lock for guiding material

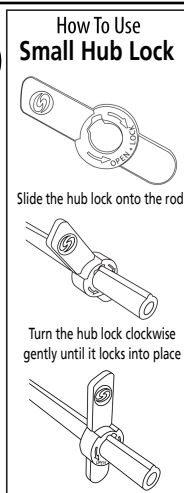

3

#### Feed Label Liner over Strip Plate

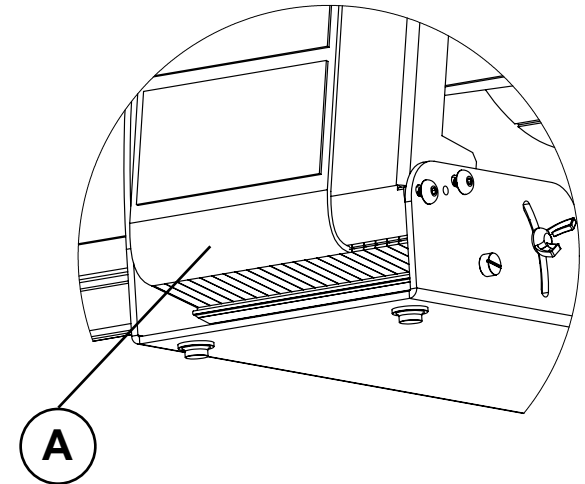

- A: Feed label liner between brush and strip plate

4

#### Separate Liner over Top of Strip Plate

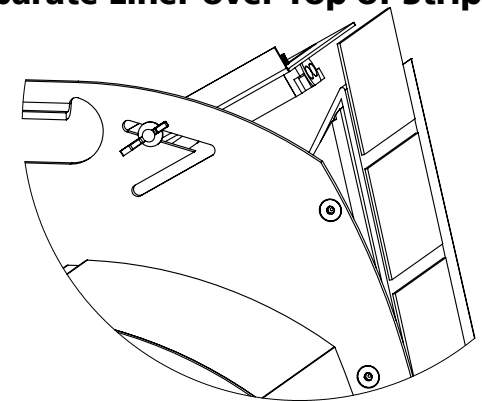

- A: Feed label liner over strip plate separating the liner from the label